

14

SALT POND

SALT POND

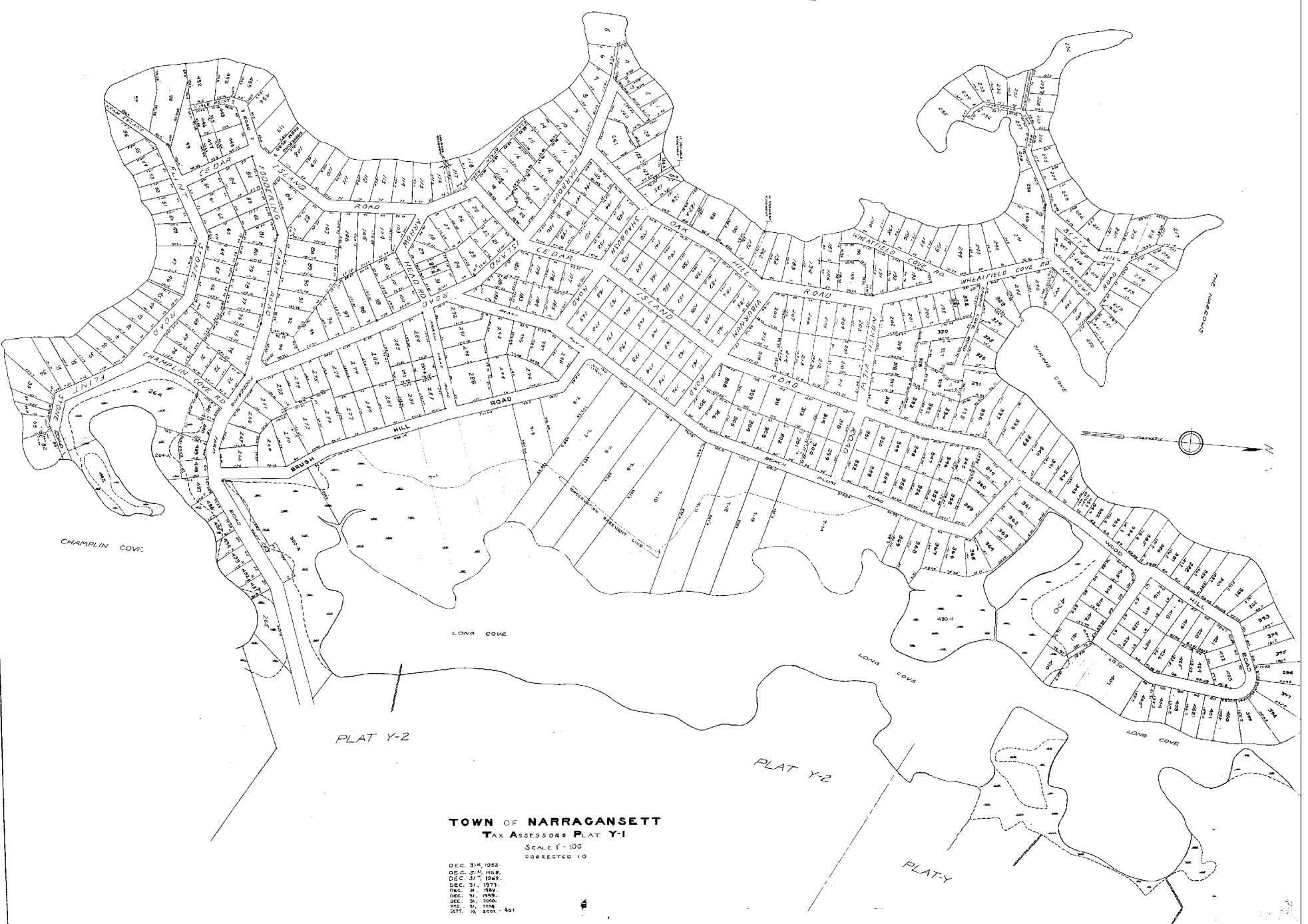

PLAT Y-2

PLAT Y-2

PLAT Y

**TOWN OF NARRAGANSETT**  
**TAX ASSESSORS PLAT Y-1**

SCALE 1"=100'  
 CORRECTED TO

- DEC. 31<sup>st</sup>, 1953
- DEC. 31<sup>st</sup>, 1956
- DEC. 31<sup>st</sup>, 1963
- DEC. 31, 1971
- DEC. 31, 1982
- DEC. 31, 1989
- DEC. 31, 2000
- DEC. 31, 2014
- EST. IN 2005 - 407

