

PLAT - Y

PLAT - T

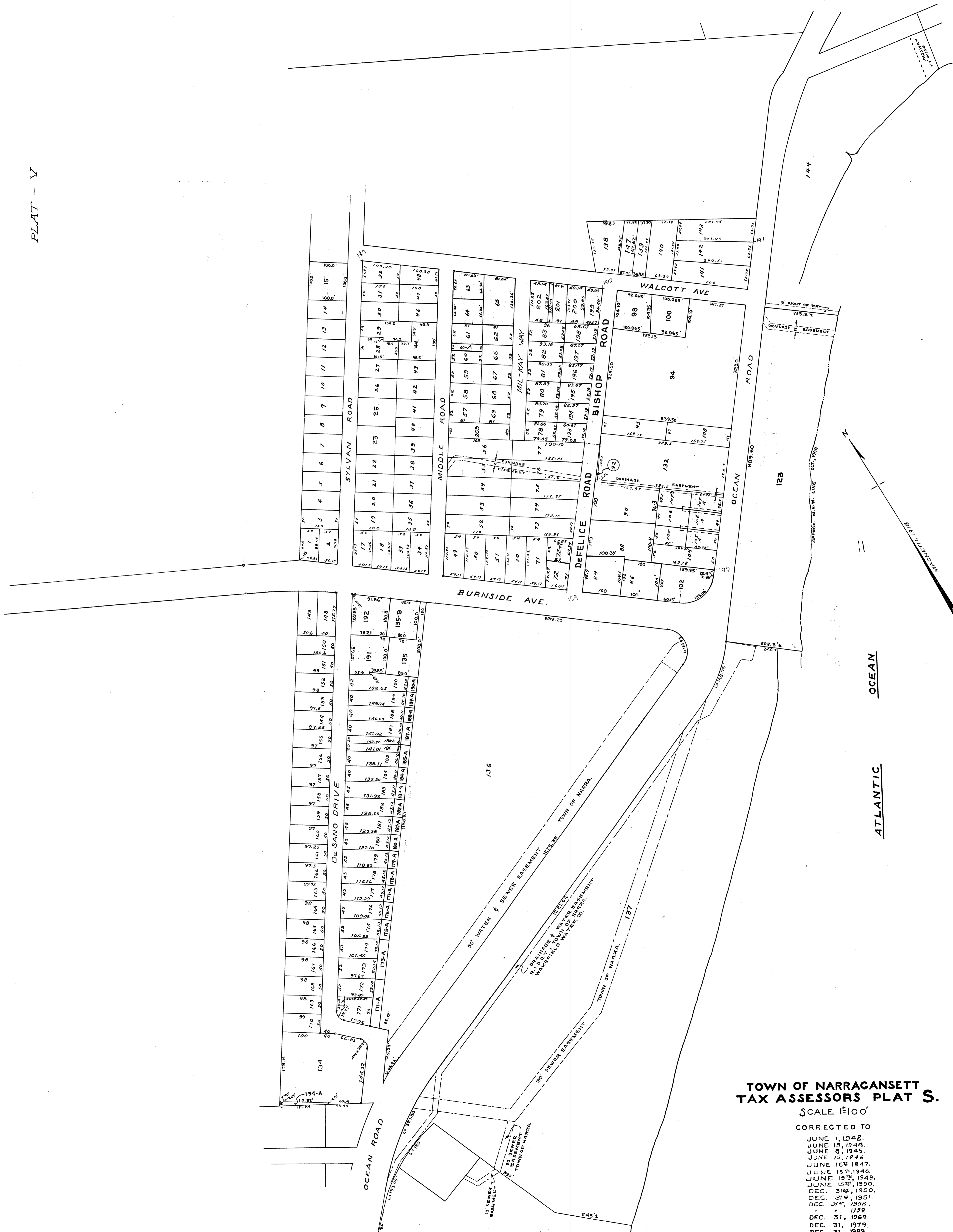

**TOWN OF NARRAGANSETT
TAX ASSESSORS PLAT S.**

SCALE 1"=100'

CORRECTED TO

- JUNE 1, 1942.
- JUNE 15, 1944.
- JUNE 8, 1945.
- JUNE 15, 1946.
- JUNE 15, 1947.
- JUNE 15, 1948.
- JUNE 15, 1949.
- JUNE 15, 1950.
- DEC. 31, 1950.
- DEC. 31, 1951.
- DEC. 31, 1952.
- " " 1959.
- DEC. 31, 1969.
- DEC. 31, 1979.
- DEC. 31, 1989.
- DEC. 31, 1993.
- DEC. 31, 2000.
- DEC. 31, 2004.

PLAT K